

REGISTRY USE:

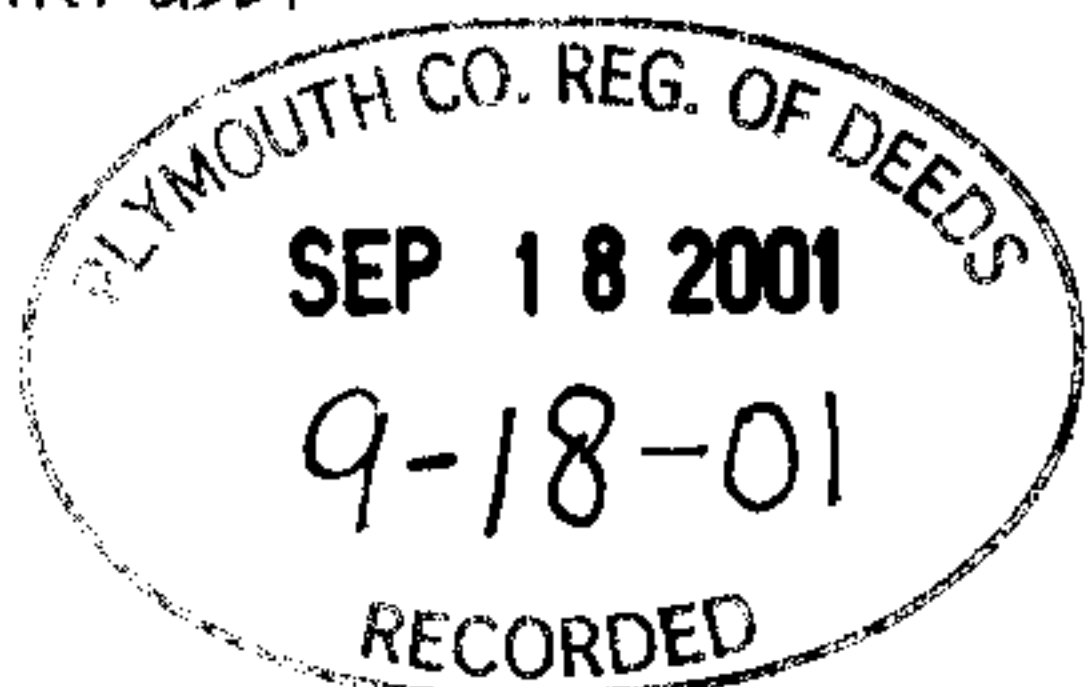

I CERTIFY THAT THIS PLAN CONFORMS WITH THE RULES AND REGULATIONS OF THE REGISTRY OF DEEDS.

Carroll Thieloni

PREPARER

01-595

GENERAL NOTES:

- 1) FLOOD ZONES ARE AS DELINEATED ON FEMA COMMUNITY PANEL NUMBER 255214 0005D MAP REVISED: JULY 2, 1987.
- 2) DATUM - M.L.W. = 0.0'
- 3) RECORD OF HISTORIC HIGH WATER LINE FROM A PLAN ENTITLED VILLAGE OF MATTAPOISETT, TOWN OF MATTAPOISETT, SCALE 30 RODS = 1 INCH PUBLISHED BY GEORGE H. WALKER & CO. BOSTON, 1879.
- 4) FIRM FLOOD RATE MAP 255214 0010 E DATED JULY 15, 1992

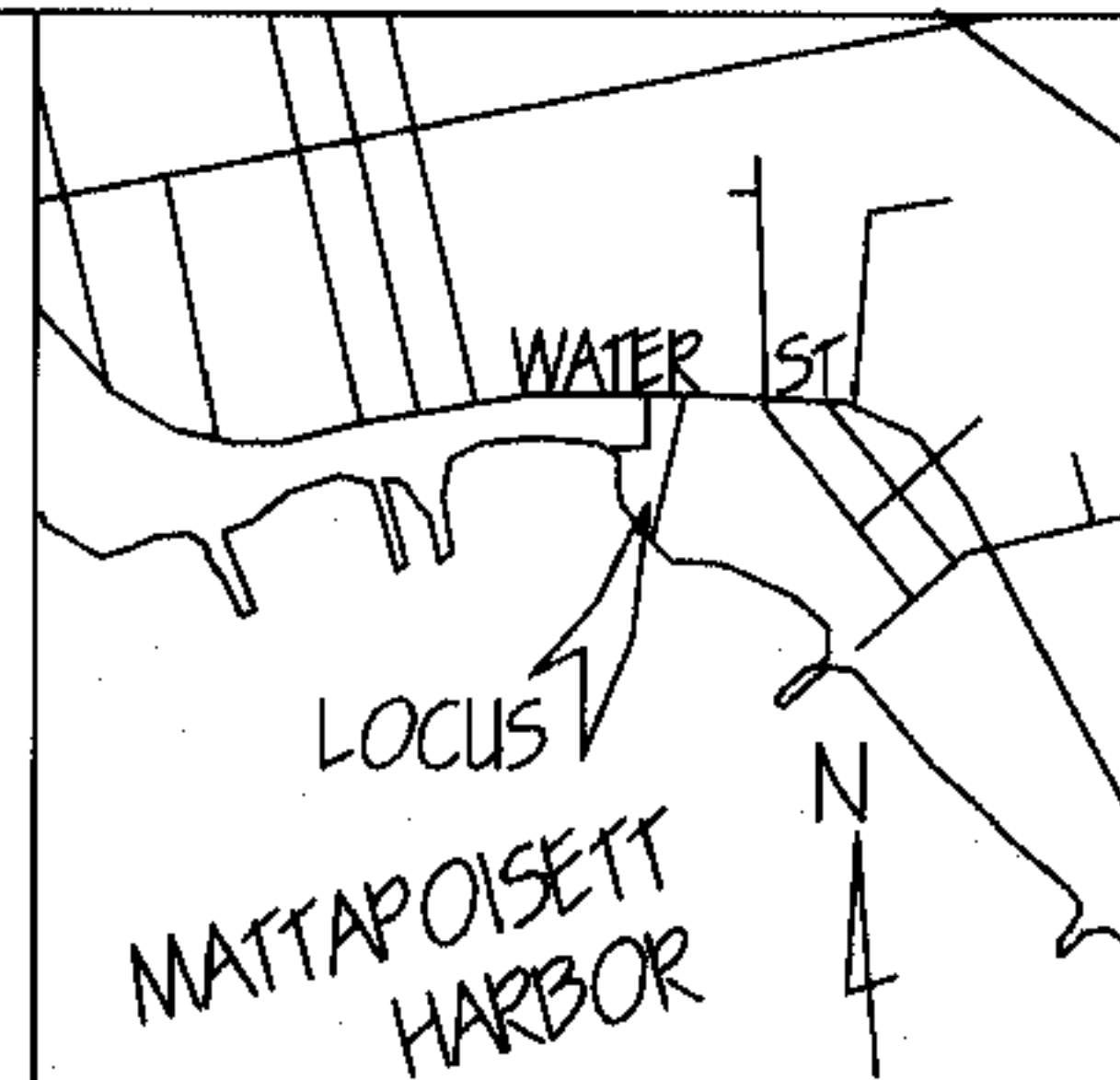

MARION QUAD

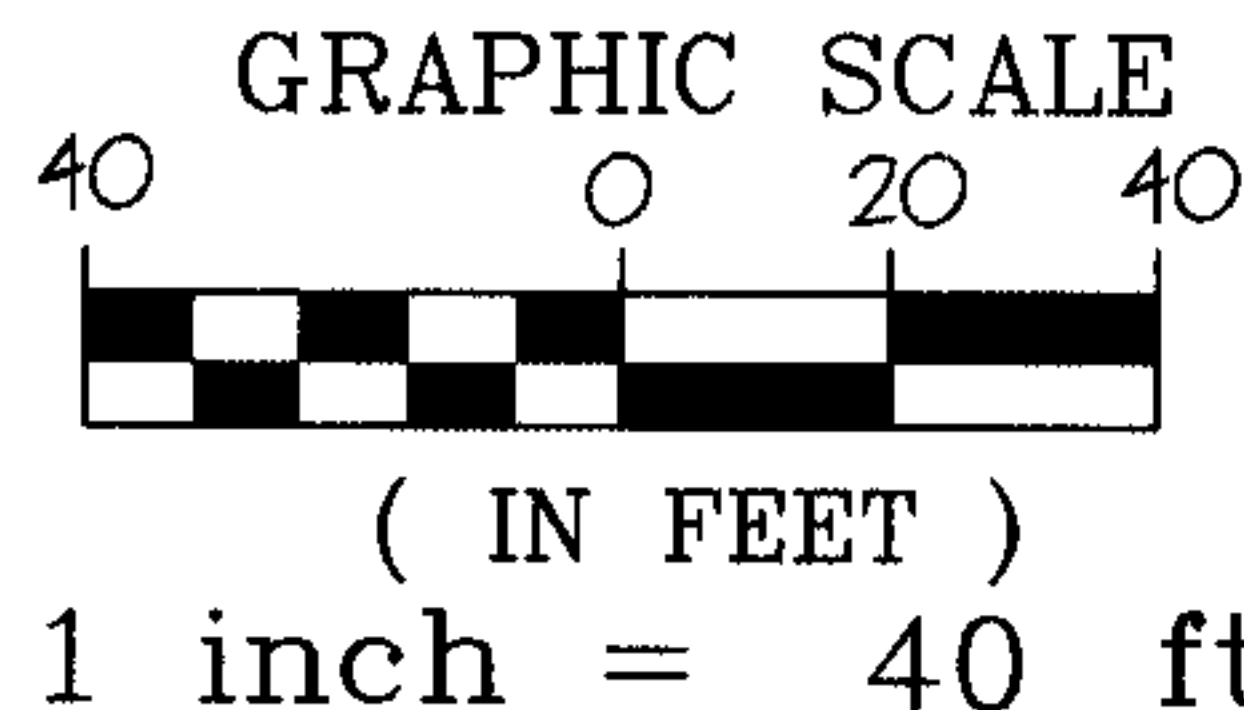
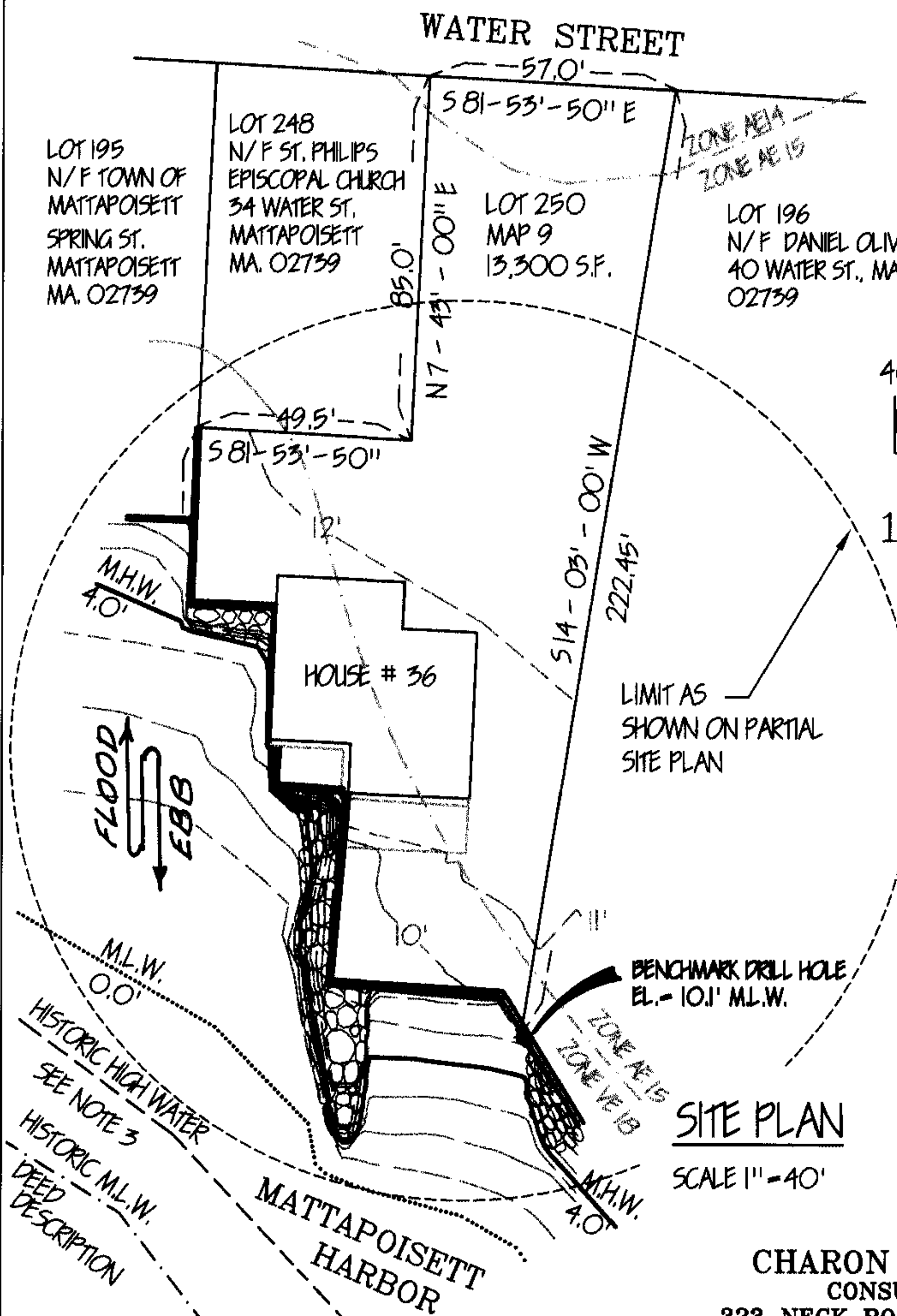

LEGEND

- M.H.W. —————
- M.L.W. - - - - -
- FLOOD ZONE BOUNDARY - - - - -
- HISTORIC HIGH WATER LINE - - - - -
- HISTORIC MEAN LOW WATER - - - - -

Plymouth County Registry of Deeds
PLAN BOOK 44 PAGE 934

PLAN ACCOMPANYING PETITION OF:
EVANS FAMILY TRUST
C/O GEORGE W. & KATHLEEN E. EVANS TRUSTEES
36 WATER STREET, MATTAPOISETT MA.
TO LICENSE AND MAINTAIN AN EXISTING
SEAWALL, JETTY, AND STONE ARMOR IN MATTAPOISETT
HARBOR, MATTAPOISETT, MA. PLYMOUTH COUNTY.
PAGE 1 OF 3 DATE SEPTEMBER 25, 1998 REV.

PREPARED BY:
CHARON ASSOCIATES, INC.
CONSULTING ENGINEERS
323 NECK ROAD, ROCHESTER, MA 02770

LICENSE PLAN NO. **6157**
Approved by Department of Environmental Protection
of Massachusetts **AUG 02 2001**

Richard B. Charon

125000

(1 of 3) '01-595

REGISTRY USE:

I CERTIFY THAT THIS PLAN CONFORMS WITH THE RULES
AND REGULATIONS OF THE REGISTRY OF DEEDS.

Carmelo Nicolosi

PREPARER

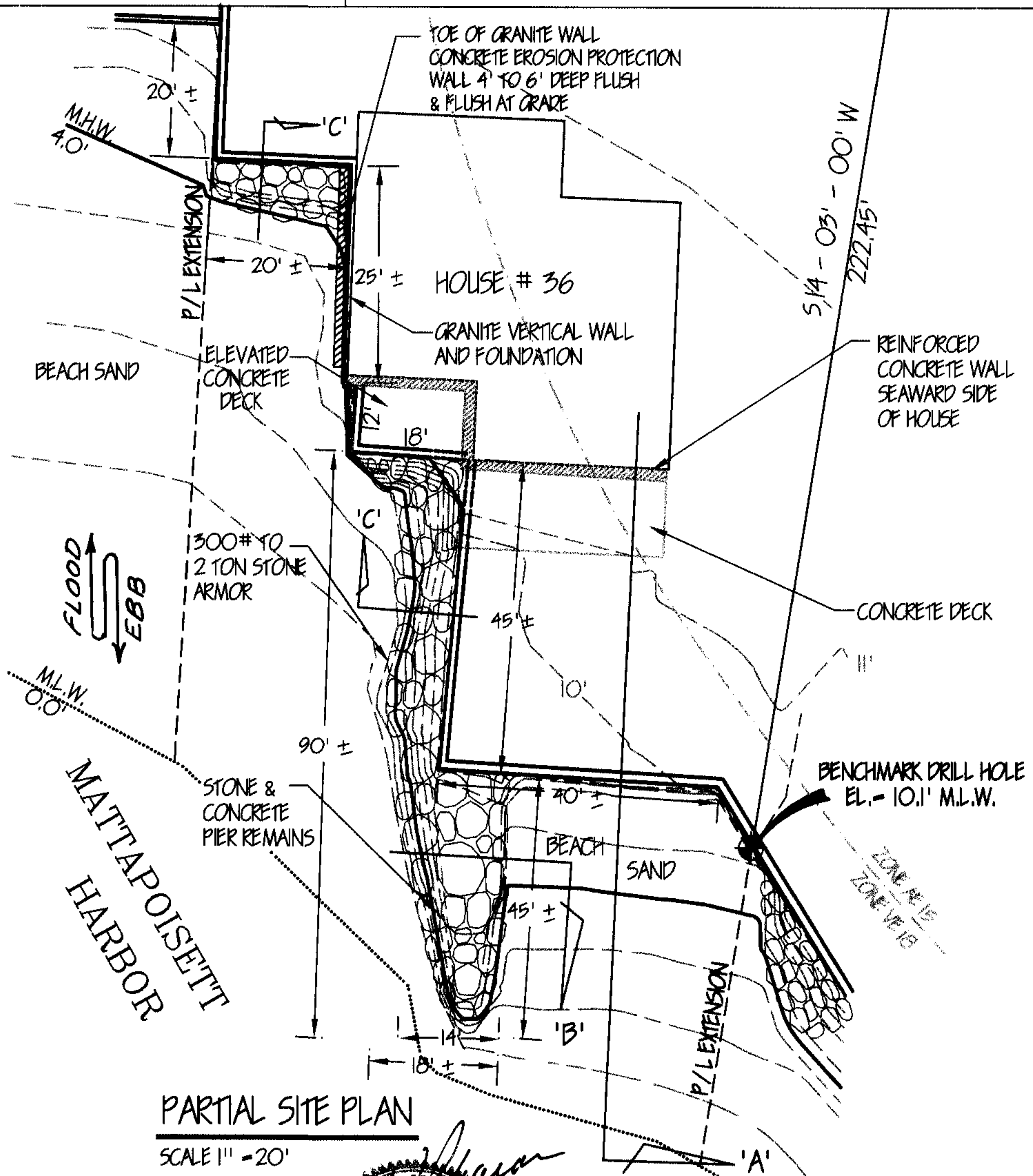

PARTIAL SITE PLAN

SCALE 1" = 20'

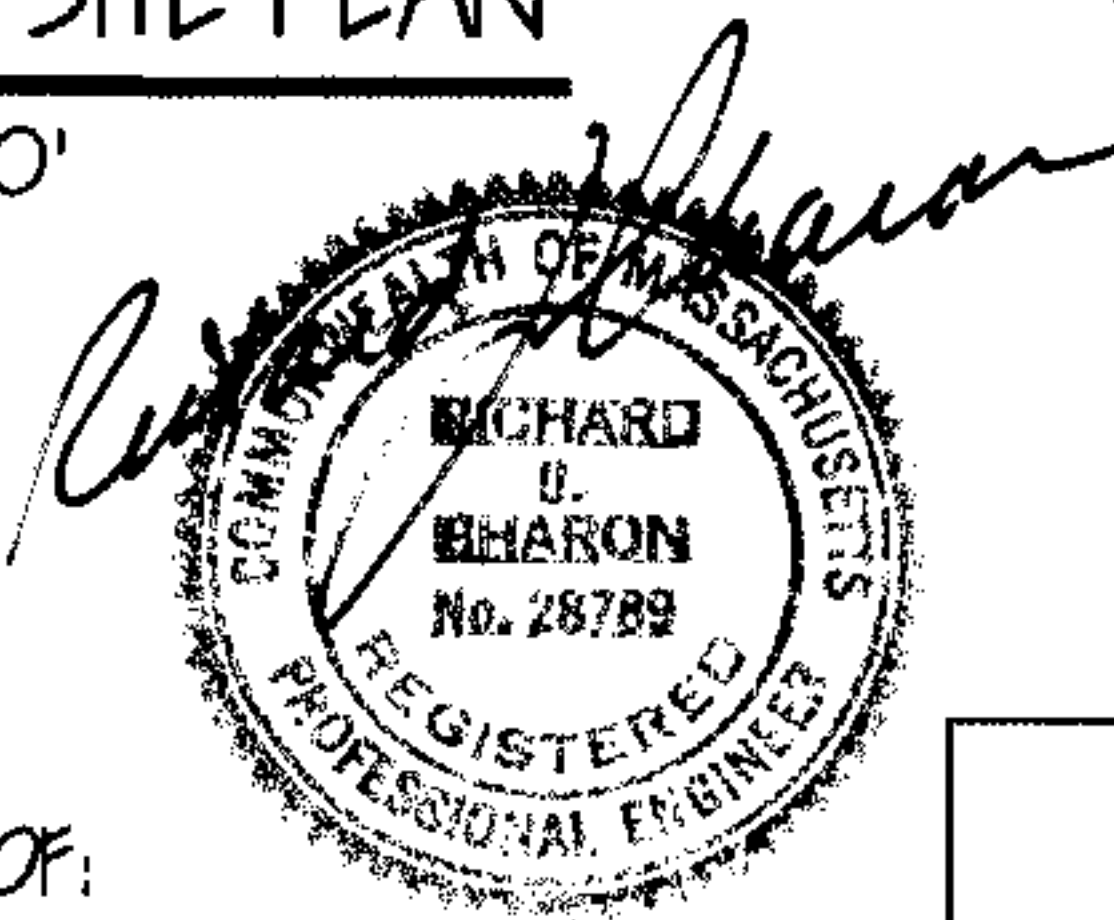

PREPARED BY:
CHARON ASSOCIATES, INC.
CONSULTING ENGINEERS
323 NECK ROAD, ROCHESTER, MA 02770

LICENSE PLAN NO. 6157
Approved by Department of Environmental Protection

AUG 02 2001

PLAN ACCOMPANYING PETITION OF:
EVANS FAMILY TRUST
C/O GEORGE W. & KATHLEEN E. EVANS TRUSTEES
36 WATER STREET, MATTAPOISETT MA.
TO LICENSE AND MAINTAIN AN EXISTING
SEAWALL, JETTY, AND STONE ARMOR IN MATTAPOISETT
HARBOR, MATTAPOISETT, MA. PLYMOUTH COUNTY.
PAGE 2 OF 3 DATE SEPTEMBER 25, 1998 REV.

Plymouth County Registry of Deeds
PLAN BOOK **44** PAGE **935**

(2 of 3) 01-595

REGISTRY USE:

I CERTIFY THAT THIS PLAN CONFORMS WITH THE RULES
AND REGULATIONS OF THE REGISTRY OF DEEDS.

Carmel Nicolai

PREPARER

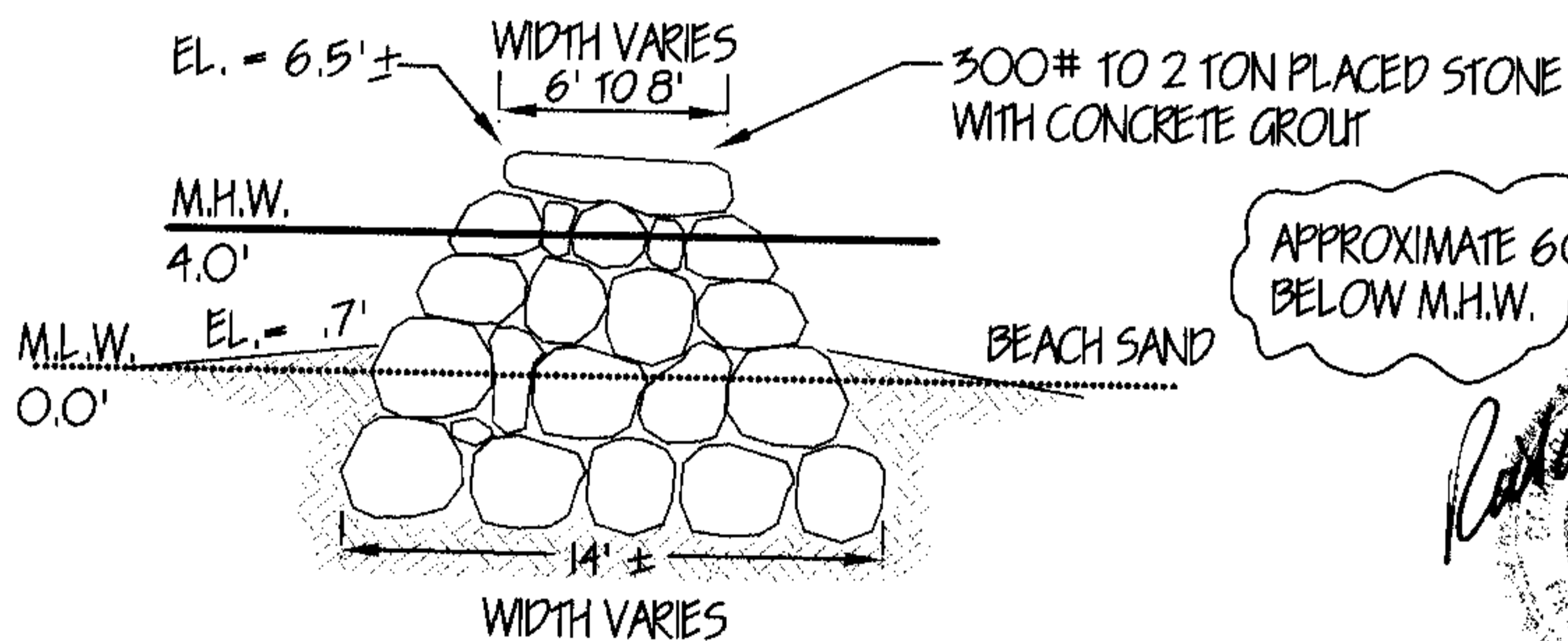
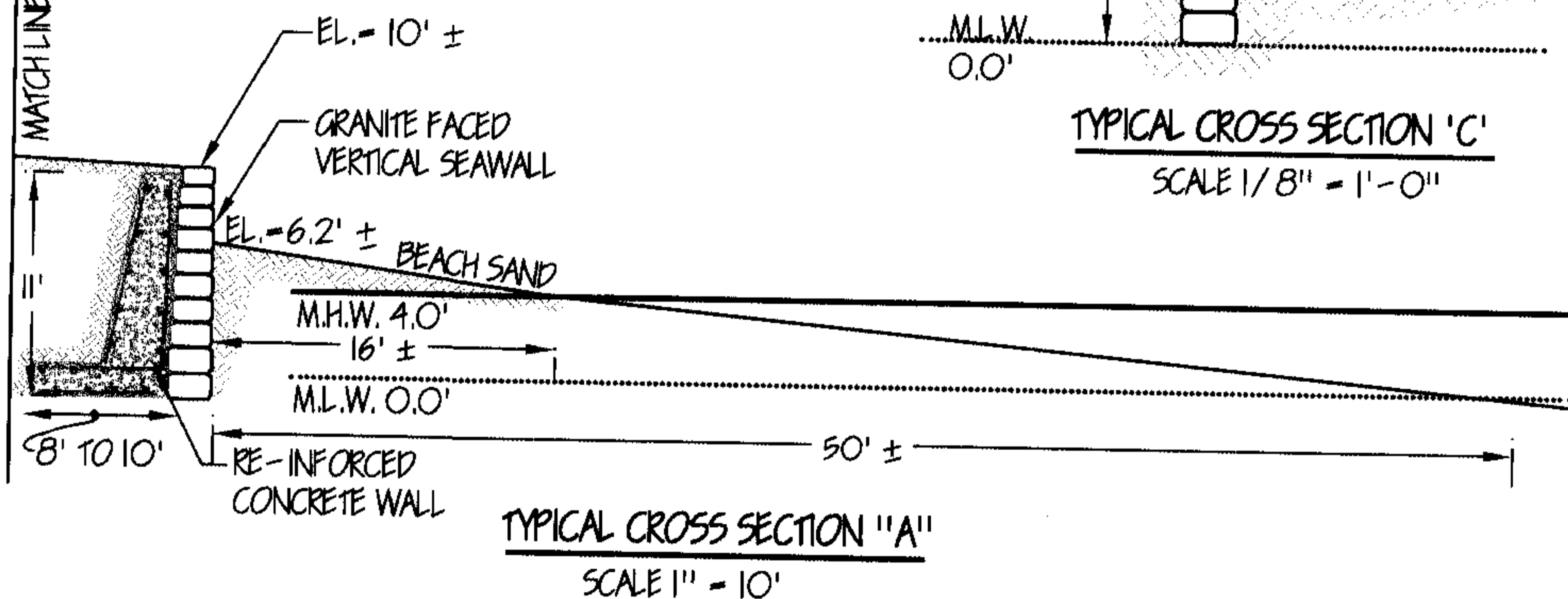
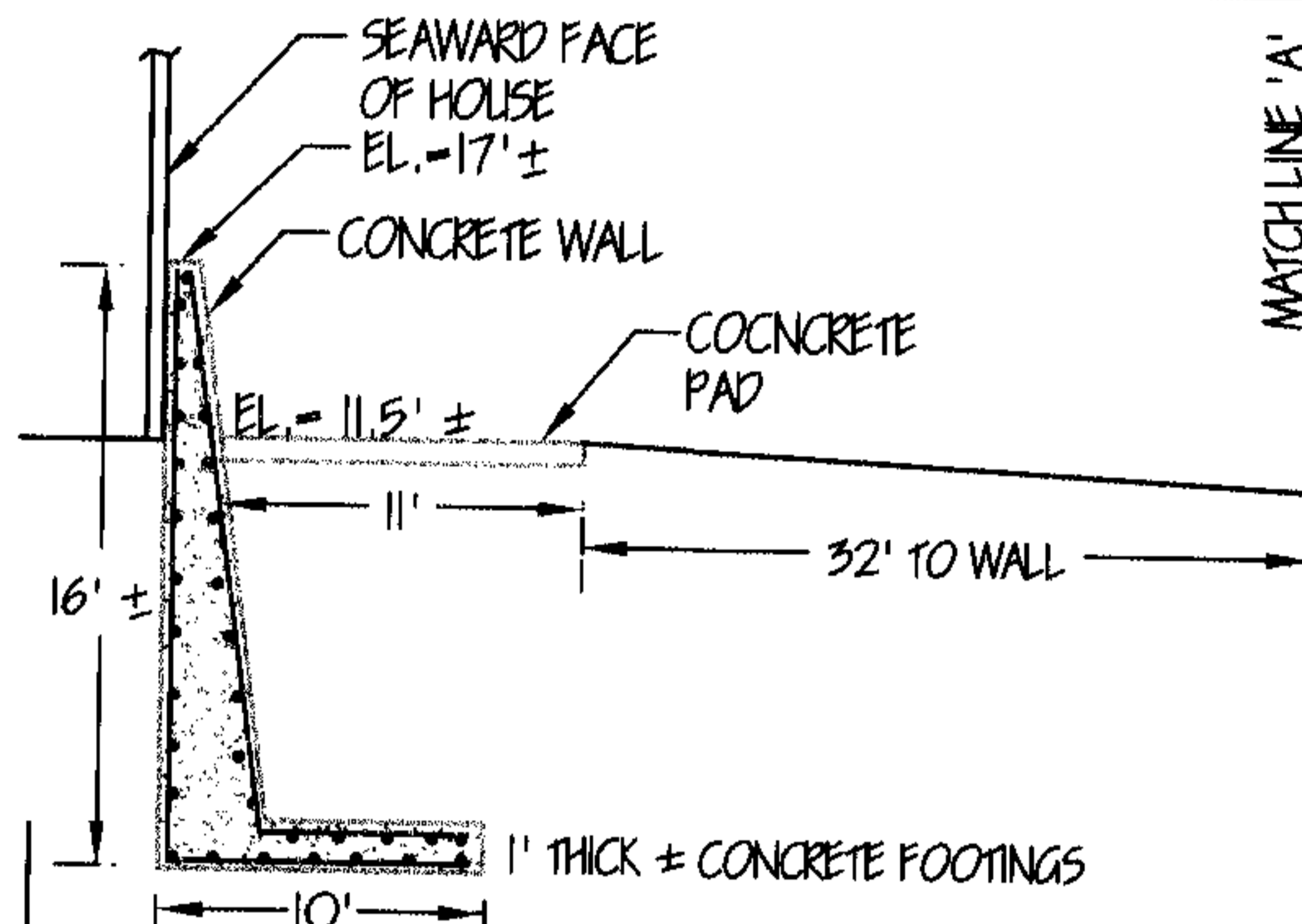

TYPICAL CROSS SECTION 'B'
SCALE 1/8" = 1'-0"

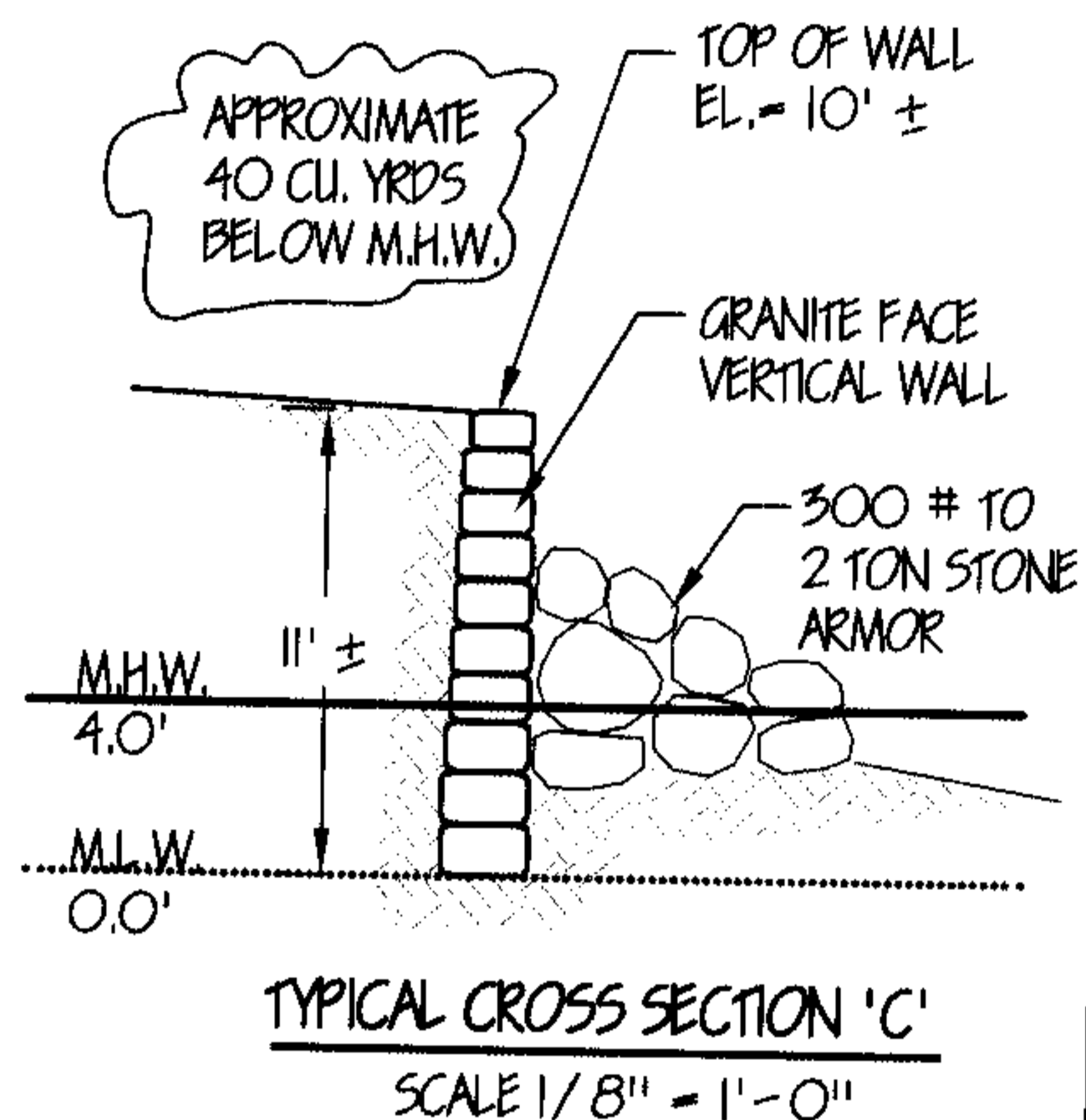

APPROXIMATE 60 CU. YDS. BELOW M.H.W.

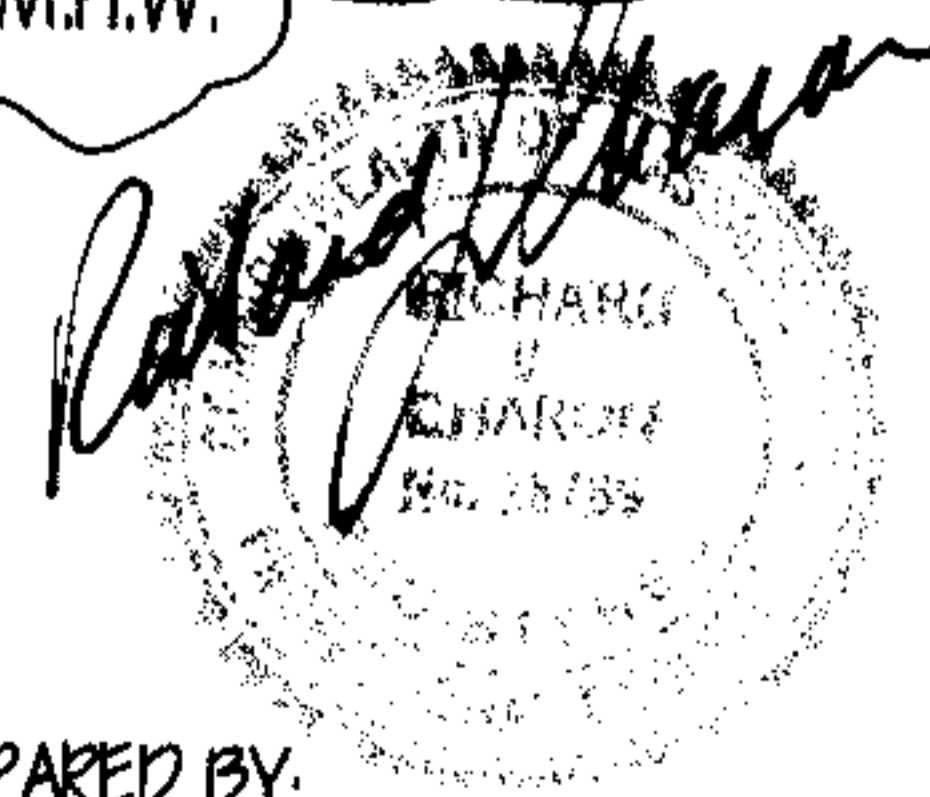

PREPARED BY:
CHARON ASSOCIATES, INC.
CONSULTING ENGINEERS
323 NECK ROAD, ROCHESTER, MA 02770

LICENSE PLAN NO. 6157
Approved by Department of Environmental Protection
AUG 02 2001

PLAN ACCOMPANYING PETITION OF:
EVANS FAMILY TRUST
C/O GEORGE W. & KATHLEEN E. EVANS TRUSTEES
36 WATER STREET, MATTAPOISETT MA.
TO LICENSE AND MAINTAIN AN EXISTING
SEAWALL, JETTY, AND STONE ARMOR IN MATTAPOISETT
HARBOR, MATTAPOISETT, MA. PLYMOUTH COUNTY.
PAGE 3 OF 3 DATE SEPTEMBER 25, 1998 REV.

Plymouth County Registry of Deeds
PLAN BOOK 44 PAGE 936

(3 of 3) 71-595