

REGISTRY USE:

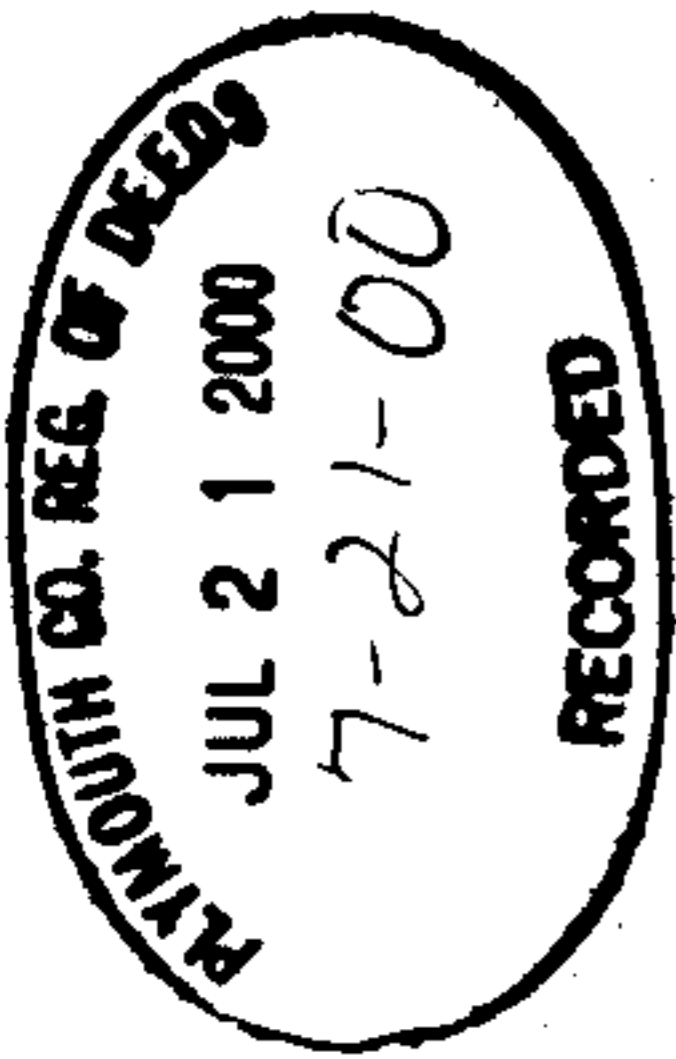

I CERTIFY THAT THIS PLAN CONFORMS WITH THE RULES
AND REGULATIONS OF THE REGISTRY OF DEEDS.

Carmelo Nicolosi
PREPARER

'00-430

GENERAL NOTES:

- 1) FLOOD ZONES ARE AS DELINATED ON FIRM COMMUNITY PANEL NUMBER 255214 0005D MAP REVISED : JULY 2, 1987.
- 2) DATUM = M.L.W. = 0.0'
- 3) THERE IS NO RECORD OF HISTORIC HIGH WATER LINE.

GRAPHIC SCALE



(IN FEET)

1 inch = 40 ft.

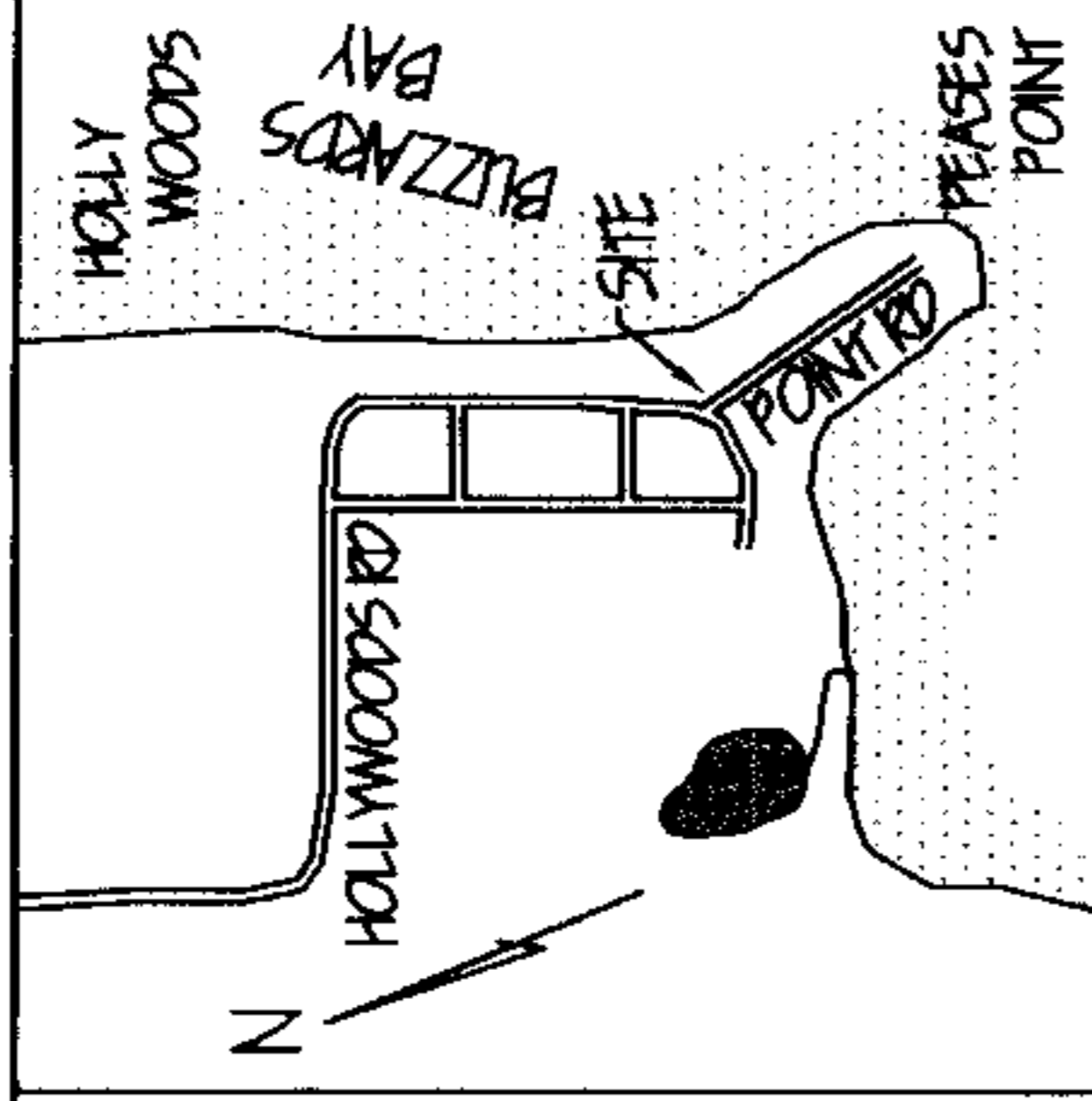

MARION QUAD. LOCUS PLAN

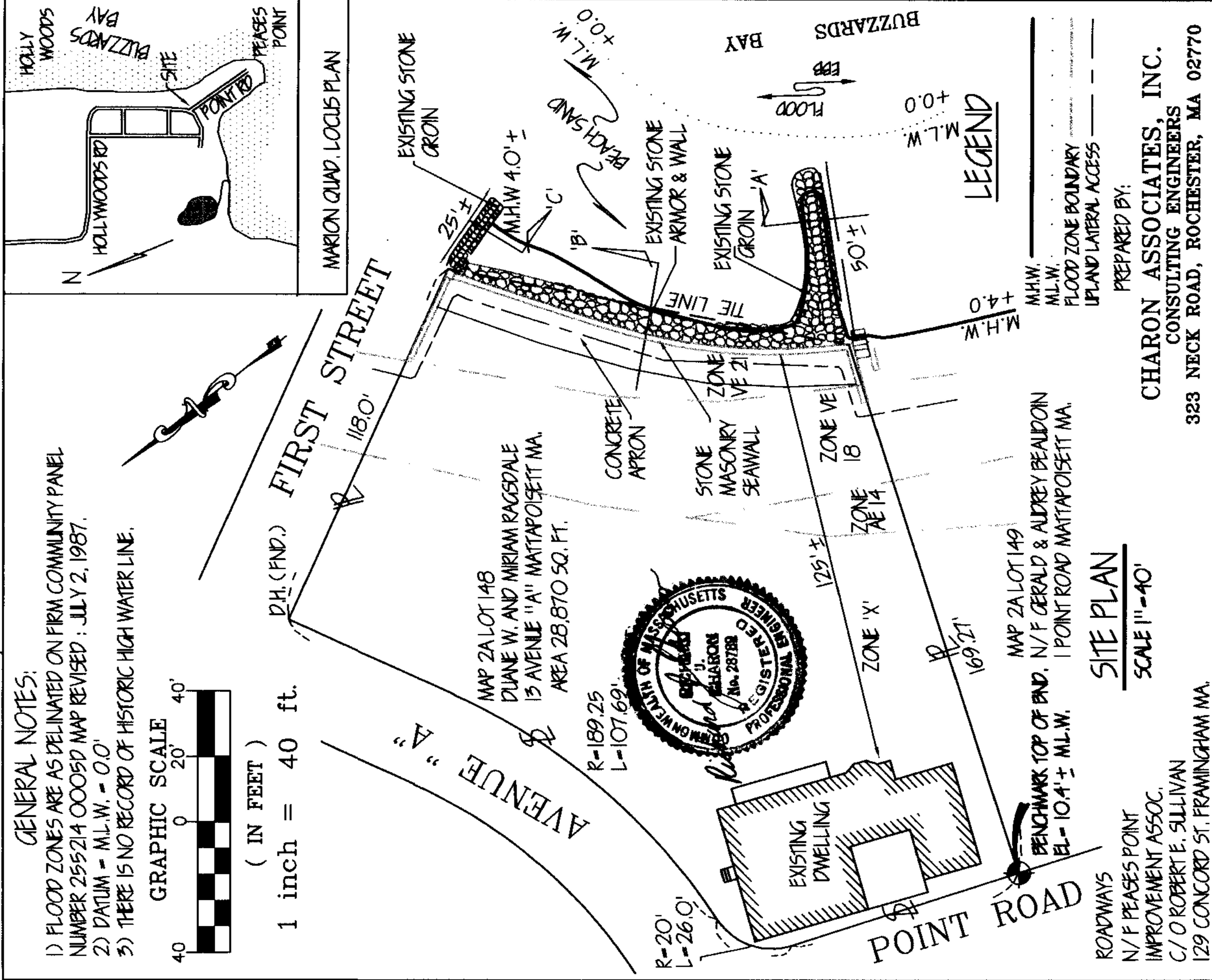

LEGEND

M.H.W. ———
M.L.W. ———
FLOOD ZONE BOUNDARY ———
UPLAND LATERAL ACCESS ———

PREPARED BY:

CHARON ASSOCIATES, INC.
CONSULTING ENGINEERS
323 NECK ROAD, ROCHESTER, MA 02770

SITE PLAN
SCALE 1" = 40'

ROADWAYS
N/F PEASES POINT
IMPROVEMENT ASSOC.
C/O ROBERT E. SULLIVAN
129 CONCORD ST. FRAMINGHAM MA.
01701

PLAN ACCOMPANYING PETITION OF:

DUANE W. AND MIRIAM RAGSDALE
13 AVENUE "A", PEASES POINT MATTAPOISETT MA.
TO LICENSE AND MAINTAIN EXISTING
CROINS, SEAWALL, AND STONE ARMOR IN BUZZARDS BAY,
MATTAPOISETT, MA. PLYMOUTH COUNTY.

PAGE 1 OF 2 DATE AUGUST 27, 1995 REV:

LICENSE PLAN NO. 8624
Approved by Department of Environmental Protection
of Massachusetts

Witch Zancane
JUN 28 2000

Plymouth County Registry of Deeds

PLAN BOOK 43 PAGE 657

0626

1386 (192) '00-430

REGISTRY USE:

I CERTIFY THAT THIS PLAN CONFORMS WITH THE RULES
AND REGULATIONS OF THE REGISTRY OF DEEDS.

Carmelo Nicolosi PREPARER

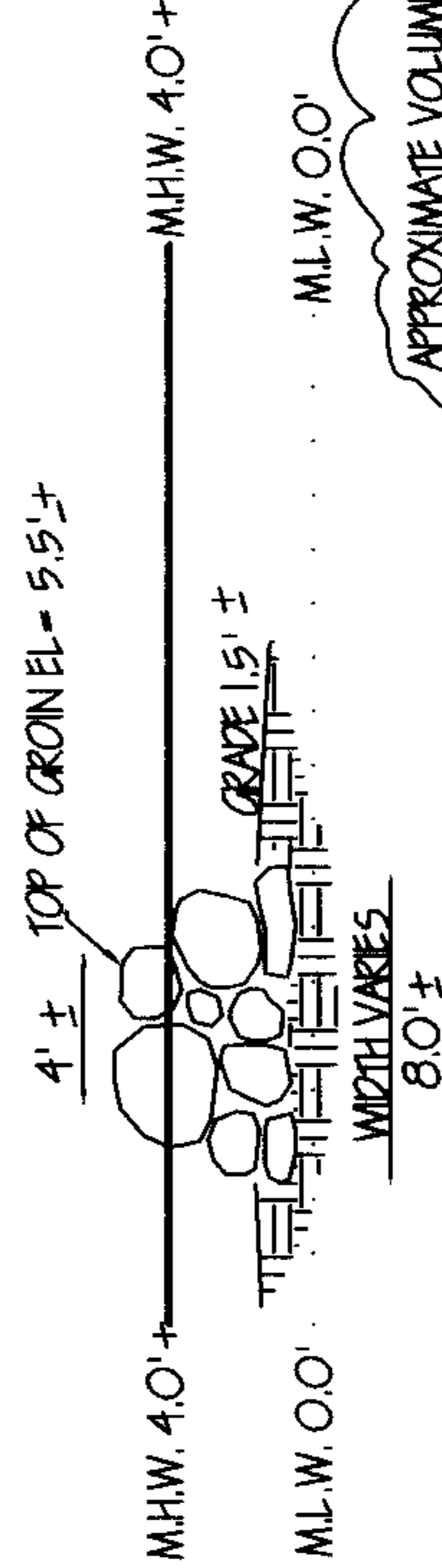

TYPICAL CROSS SECTION OF GROIN

SECTION 'A' SCALE 1/8" = 1'-0"

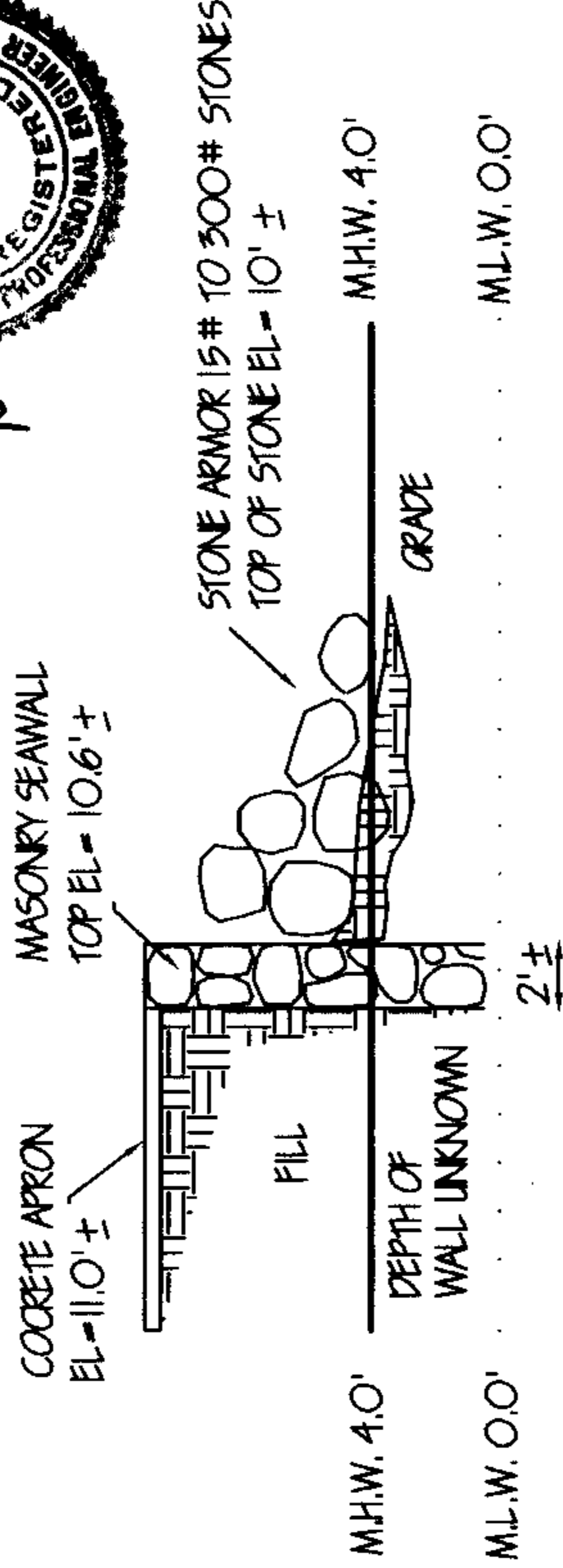
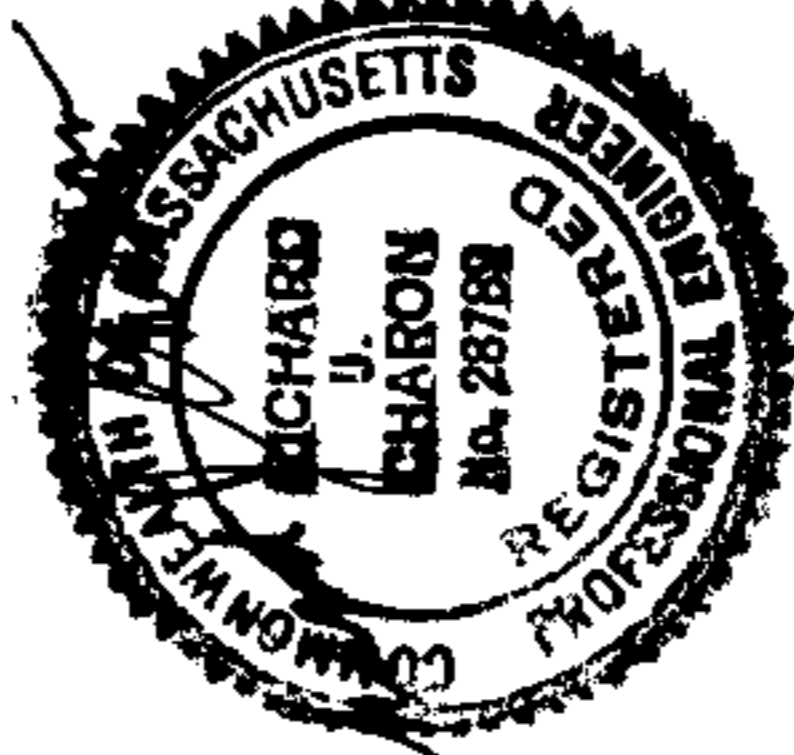

TYPICAL CROSS SECTION OF WALL AND STONE ARMOR

SECTION 'B' SCALE 1/8" = 1'-0"

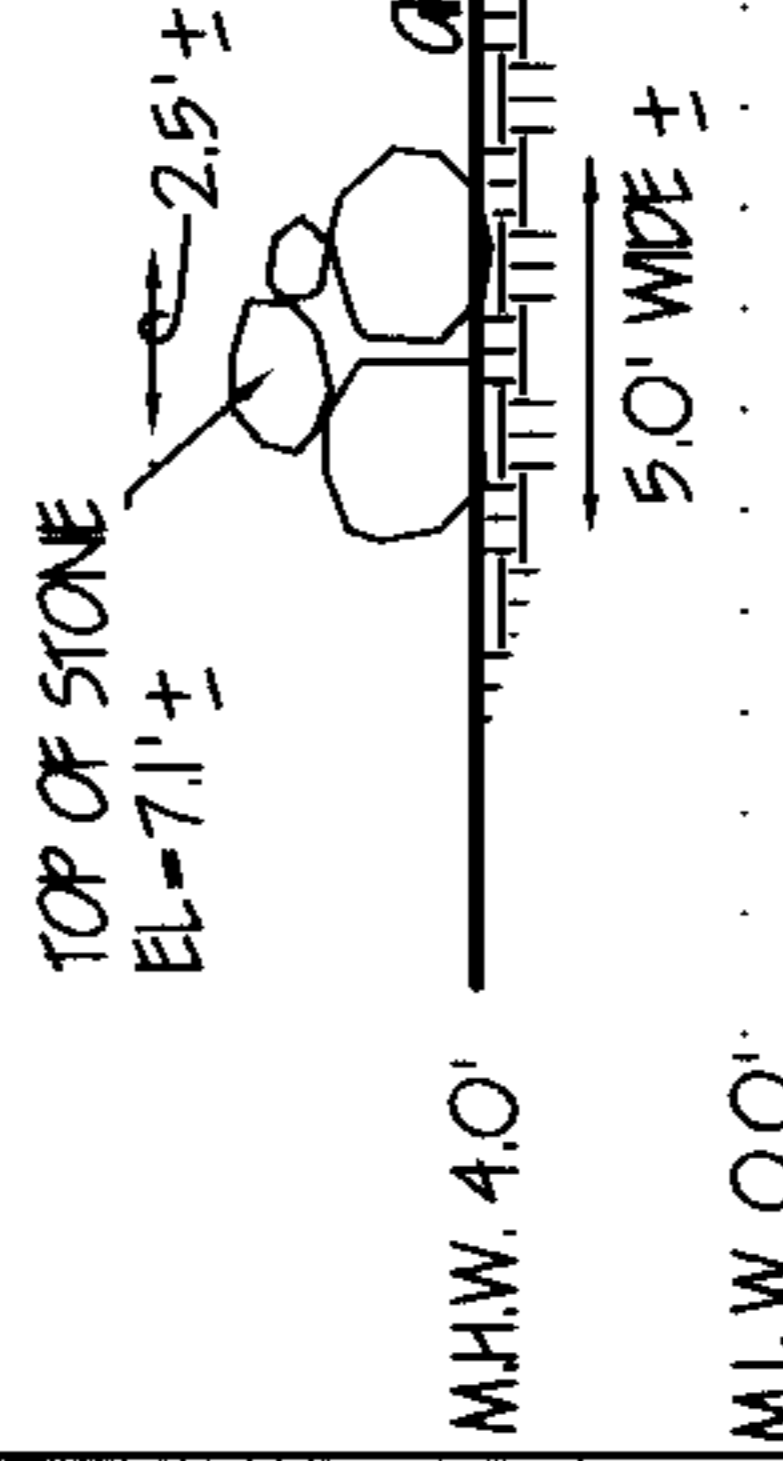

TYPICAL CROSS SECTION OF GROIN

SECTION 'C'

SCALE 1/8" = 1'-0"

PREPARED BY:
CHARON ASSOCIATES, INC.
CONSULTING ENGINEERS
323 NECK ROAD, ROCHESTER, MA 02770

PLAN ACCOMPANYING PETITION OF:
DUANE W. AND MIRIAM RAGSDALE
13 AVENUE "A", PEASE'S POINT MATTAPOISETT MA.
TO LICENSE AND MAINTAIN EXISTING
GROINS, SEAWALL, AND STONE ARMOR IN BLIZZARDS BAY,
MATTAPOISETT, MA. PLYMOUTH COUNTY.
PAGE 2 OF 2 DATE AUGUST 27, 1995 REV:

LICENSE PLAN NO. 86024
Approved by Department of Environmental Protection
Date JUN 28 2000

Plymouth County Registry of Deeds

PLAN BOOK

43

PAGE

658

(292) '00-430